

3630 TRYCLAN DR

CHARLOTTE, NC



FOR LEASE. FOR LEASE. FOR LEASE. FOR LEASE. FOR LEASE.

THE NEIGHBORHOOD

LOSO

Located at the intersection of Tryclan Drive and Dewitt Lane in the Lower South End neighborhood of Charlotte, NC, there is an **entertainment district** that is easily accessible by light rail via the Scaleybank Station located only 500 yards away!

Since 2020, this section of LoSo has seen over 50,000 SF of leases signed with entertainment, fitness and food and beverage users.

The LoSo neighborhood overall is experiencing **rapid residential growth** with over 4,900 units delivered or under construction within a mile from this intersection.

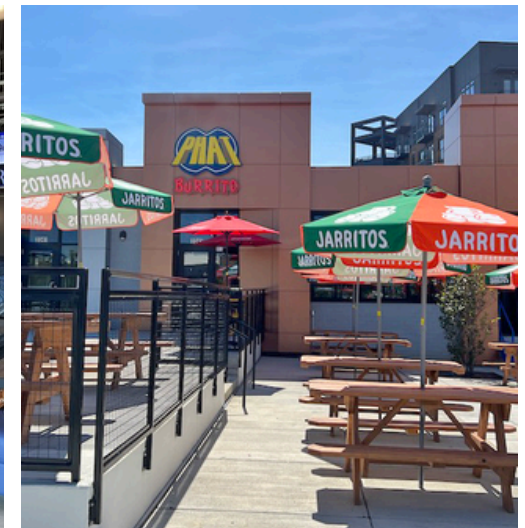
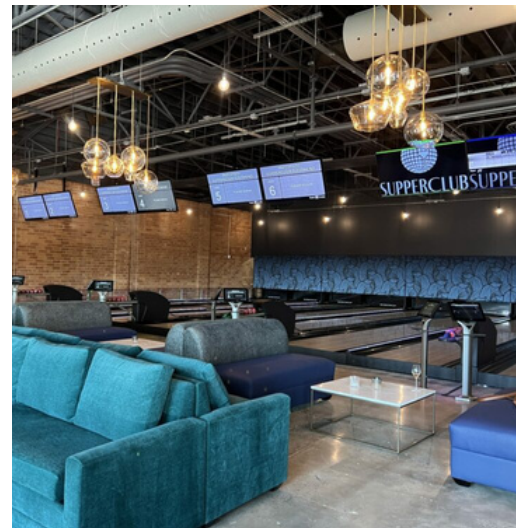



SITE PHOTOS ▾



FLOOR PLAN

Features:

- Space includes two bathrooms, conference room, and several custom, private offices built from shipping containers
- Single row of columns with a unique exposed bow truss roof
- Two large floor drains
- Two dock high overhead doors
- 20 existing onsite parking spaces
- 14' clear height

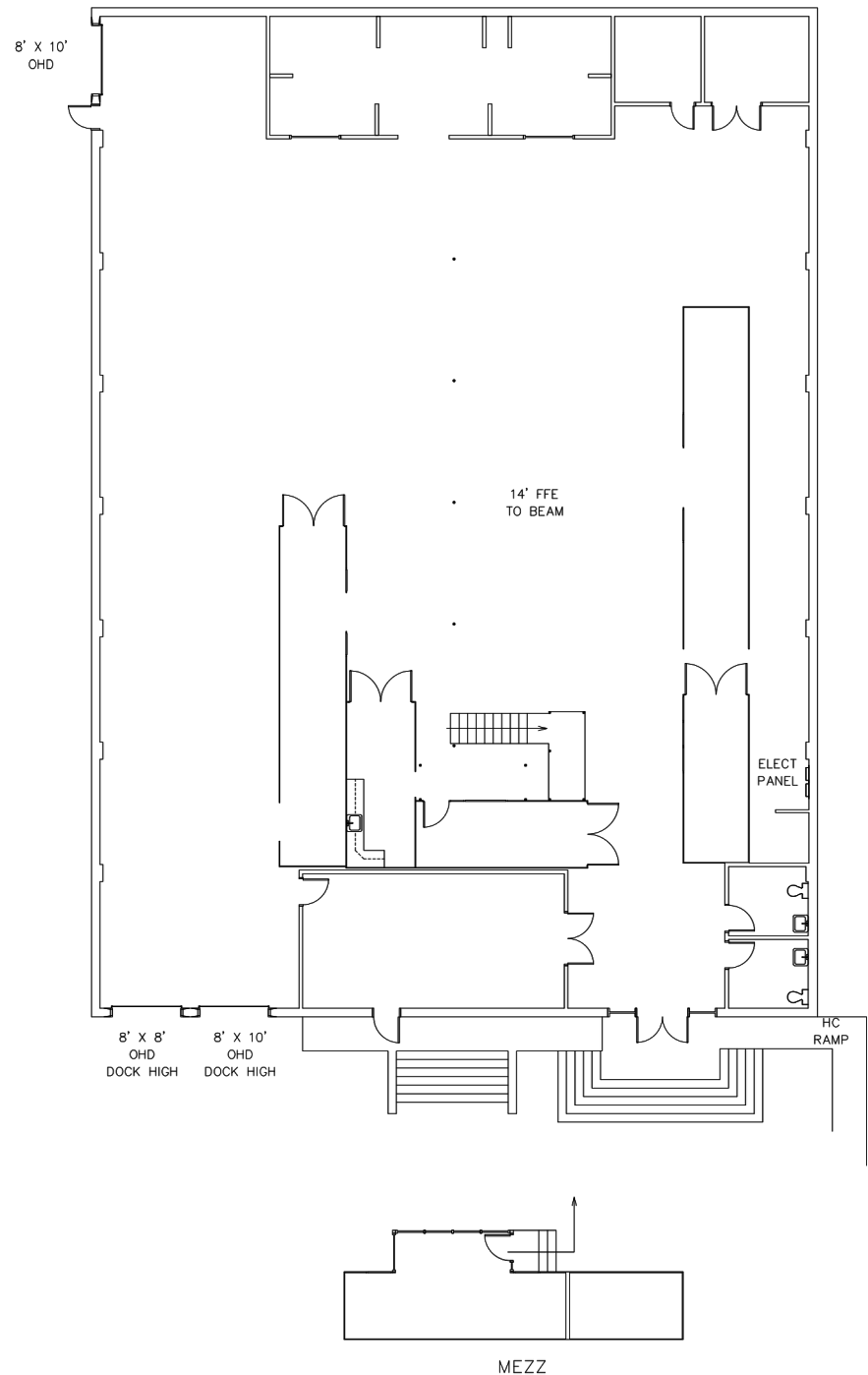

**AREA
RETAIL** ▾



AREA
RESIDENTIAL ▾





Protagonist



Queen Park Social



Chef Alyssa's Kitchen



Lenny Boy



Gilde

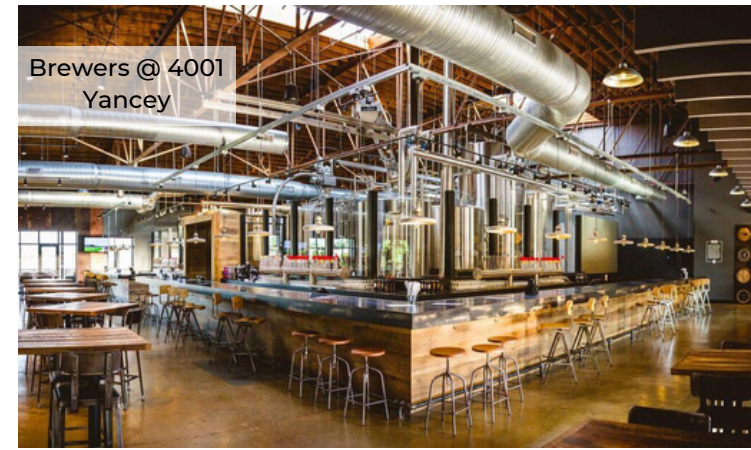

Brewers @ 4001 Yancey



Olde Mecklenburg Brewery



The Everyday Market



Sugar Creek Brewing Co.

3630 TRYCLAN DR

CHARLOTTE, NC

GET IN TOUCH 



JAY MITCHENER

(704) 576-2772

jay@thriftcres.com

