



RETAIL FOR LEASE ▾

Apex SouthPark

Charlotte, NC 28211



ABOUT THE PROPERTY ▾



Just steps from SouthPark Mall and overlooking a streetscape lined with sensational restaurants and top retail brands, Apex is centrally located in the heart of exclusive SouthPark. Minutes from uptown, and home to hundreds of events, this high-energy area is one of Charlotte's most exciting and sought after locations.

 4425 Sharon Road, Charlotte, NC 28211

Space Available	1,202 - 7,632 SF
Delivery Condition	2nd Generation & Cold Dark Shell
Target Use	Retail

- Site Features**
- 90K SF Retail & Entertainment
 - Located below 345 luxury apartments
 - 175-room Hyatt Centric on site
 - Located on the new South Park Loop; creating a walkable neighborhood destination
 - 1,100 parking spaces in 4-level deck

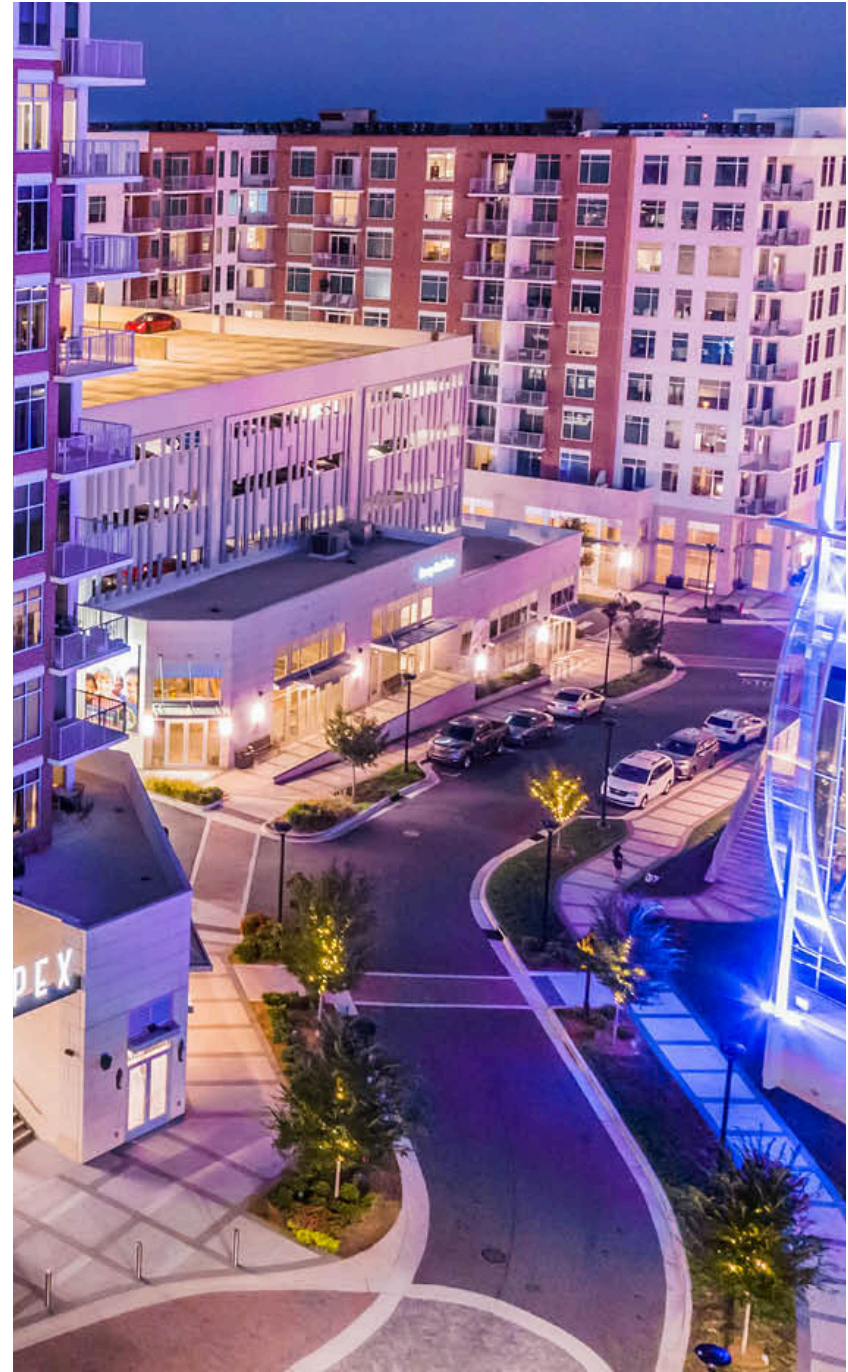

PROPERTY DETAILS

LOCATION

SITE PLAN

CONTACT

SITE PLAN



PROPERTY DETAILS

LOCATION

SITE PLAN

CONTACT

SUITE	ENTRANCE LEVEL	TENANT	SPACE SIZE (SF)
S1-A	Sharon Road	Brock Moran	2,167
S1-B	Sharon Road	iCryo	2,597
S2-A	Sharon Road	Available	1,421
S2-C	Sharon Road	Available	2,251
S2-D	Sharon Road	Sassy Nails	2,849
S3	Sharon Road	Gourmand Market	2,836
S5	Sharon Road	Steak48	9,146
S7	Sharon Road	Polestar	2,620
S8	Sharon Road	Saatva	4,023
S10	Sharon Road	Yardbird	4,399
S11	Sharon Road	Snooze AM Eatery	4,030

SUITE	ENTRANCE LEVEL	TENANT	SPACE SIZE (SF)
S12	Sharon Road	Available	1,202
S13	Sharon Road	Moon Thai	4,357
S14	Sharon Road	Salata	1,652
C1-A	Carnegie Blvd	Hustle House Fitness	3,142
C1-B	Carnegie Blvd	Ivy Rehab	2,322
H-1	Carnegie Blvd	Calle Sol Latin Cafe & Cevicheria	3,840
H-2	Carnegie Blvd	Palestra Boutique Spa	1,912
H-3	Carnegie Blvd	Palestra Boutique Spa	3,806
M1	Carnegie Blvd	Available	7,632
M2	Carnegie Blvd	8 the Salon	5,962
M3	Carnegie Blvd	InTown Golf Club	13,482



GET IN TOUCH ▾



Peyton Gehron
Peyton@ThriftCRES.com
704-650-0605

Lucy Butler
LButler@ThriftCRES.com
704-420-3858



PROPERTY DETAILS

LOCATION

SITE PLAN

CONTACT